



## 8300lm WUXGA DLP Movie Projector Large Venue Projector

Our Product Introduction

### Basic Information

- Brand Name: Yeoan
- Model Number: YA806
- Minimum Order Quantity: 5
- Packaging Details: Packaging Box Dimensions (WxDxH mm): 732\*352\*630
- Delivery Time: 15 days
- Payment Terms: L/C, T/T, Western Union



### Product Specification

- Brightness: 8300lm
- Display Tech.: 3LCD SONY
- Light Source: Laser Light Source
- Standard Resolution: WUXGA
- Lens Optional: Yes
- Lens Ratio: 1.30-3.02
- Lens Shift: V: 50% 10%、 H:±20%
- Aspect Ratio: Native:16:10 Compatible: 4:3/16:9
- Focus Mode: Manual Or Motorized Optional
- Keystone Correction: V: ±30° H ±30°

for more products please visit us on [projector-hd.com](http://projector-hd.com)

## Product Description

### 8300lm 3LCD Large Venue Projectors For Commercial uses

#### Product Description:

This projector is loved by users around the world for its restrained and elegant design. It has incredibly high brightness, a motorized lens and lens position memory function to meet various installation needs. Its maintenance-free reliable operation time of up to 20,000 hours and optional IP6X sealed engine design ensure constant brightness and color uniformity, making this series ideal for large venues such as museums, auditoriums, lecture halls, stadiums, as well as rental and staging purposes.

#### Product feature:

- 3LCD technology
- 30,000 hours light source lifetime
- High brightness to 8300 lumen
- WUXGA (1920\*1200 pixels)
- Supports 4K HD input
- 360° all-round projection (with protective cover)
- Multiple optional lens for choice both electric and manual
- Compact design with net weight about 24kg
- HDBaseT port can make Hd signal real-time transmission possible

#### Specifications:

Key parts		
	Lens	optional
	Light source	Laser
Brightness		
	Brightness	8300lm
Overall Spec		
Panel	Display Panel	3x0.76" sony
	Display Technology	Liquid Crystal Display
	Native Resolution	WUXGA (1920 x 1200)
Light source Life time	Normal mode	20000hrs
	ECO mode	20000hrs
Projection Lens	Zoom/Focus	Powered
	Throw Ratio(16:10)	1.30-3.02
	F	F1.7~2.0
	f	21.8-49.8
	Zoom Ratio	*2.3
	Screen size (Performance guarantee range)	50-500 inch (80-200 inch)
	Lens Shift V	+50%,-10%
	Lens Shift H	±20%
CR	Contrast Ratio(Min)	100000:1
Noise	Noise(dB)	Normal(90%): 32dB ECO1(75% : 27dB ECO2(45% ): 27dB
Uniformity	Uniformity(Actual Min) -JISX6911	80%
AR	Aspect Ratio	Native:16:10 Compatible: 4:3/16:9/normal
Terminal(I/O port)		
Input	VGA	*1
	HDMI 1.4(IN)	*2
	USB-A	*1 (5V/1.5A)
	USB-B	*1(Display)
	RJ45	*1(Display)
	DVI-D	*1
	HD BaseT	*1
	HD-SDI(3G-SDI)	Optional
	Video	N/A
	Audio in (mini jack,3.5mm)	*1 (VGA/DVI-D share) 第 1 ,共 4
Output	VGA/VGA IN	*1
	HDMI 1.4(OUT&IN)	*1

	Audio out(mini-jack,3.5mm)	*1
Control	RS232	*1
	RJ45	*1 (Control)
	USB-B	*1 (For upgrade)
	Wired Remote(IN)	*1
	Wired Remote(OUT&IN)	*1
General Spec		
Audio	Speaker	N/A
Cooling	Dust filter free	Closed inner circulation design
Power Consumption	Power Requeirements	100~240V@ 50/60Hz
	Power Consumption (Boost) (Max)	700
	Power Consumption (Normal) (Max)	650
	Power Consumption (ECO1) (Max)	550
	Power Consumption (ECO2) (Max)	400
	ECO Standby Mode Power Consumption	<0.5W
Temp.&Humidity	Operating Temp.	5 to 40deg.C
	Operating humidity.	20-80%
	Store Temp.	-10 to 50deg.C
	Store Humidity.	20-80%
Other Functions		
Keystone	Keystone Correction	V: ±30° H:±30° Pincushion/Barrel Correction 6 Corner Geometry correction 4 Corner Correction Grid ImageTune correction
OSD	Languages	26 languages: English, German, French, Italian, Spanish, Polish, Swedish, Dutch ,Portugese, Japanese, Simplified Chinese, Traditional Chinese, Korean, Russian, Arabic, Turkish, Finnish, Norwegian, Danish, Indonesian, Hungarian, Czech, Kazak,Vietnamese,Thai, Farsi
LAN Control	LAN Control-RoomView (Crestron)	Yes
	LAN Control-AMX Discovery	N/A
	LAN Control-PJ Link	Yes
Scanning Frequency	H-Synch Range	15~100KHz
	V-Synch Range	24~85Hz
Display Resolution	Computer Signal Input	VGA, SVGA, XGA, SXGA,WXGA,UXGA,WUXGA,4K@30Hz
	Video Signal Input	480i, 480p, 576i, 576p, 720p, 1080i and 1080p
SW setting	Auto Setup	INPUT SEARCH,AUTO PC,
	Blank	Yes
	Suspend	Yes(5miniutes no singnal as default)
	Picture mode	Dynamic,Standard,Cinema,Colorboard, DICOM,blackboard(green)
	Cooling time	0s,30s,Normal
	Closed caption	N/A
	High altitude	Yes(1400~3650m)
	Auto Ceiling	Yes
	D-Zoom	1~33
Others	360° projection	360° all-round projection
	Edge Blending	N/A
Dimension&Weight		
	MAX Dimensions (WxHxD mm)	600*218*503.3
	Net. Weight (KG)	~24kg
	Single Packaging Box Dimensions (WxHxD mm)	732*352*630
	Single Gross. Weight (KG)	~29kg

	Double Packaging Box Dimensions (WxHxD mm)	805*452*716
	Double Gross. Weight (KG)	~33kg
Accessory		
	Manual Languages	Chinese,English
	Standard Accessories	Power cord(3m,Black), Remote control&RC Battery
Regulation List		
China	CCC	√
	CECP	X
	CEL-(2016/10-)	X
WW	CB	√
US	cTUVus	√
	FCC	√
	FDA	√
EU	CE-EMC	√
	CE-LVD	√
	CE-ERP	√
EMC Class		
	EMC Class	Class A@3dBm

#### **Projector appearance:**







High brightness with stable and reliable performance

**Application scenarios:**  
**outdoor projection, extra-large meeting rooms.**



## Support T hold 4K HD input bloom ultra HD field of view

The ultra-clear 4K\* resolution is 4 times that of 1080P. Under the 100-inch giant screen, the sharp and clear picture is still visible. The picture performance is clearer and brighter, the details are rich and realistic, and the degree of restoration is higher menu.

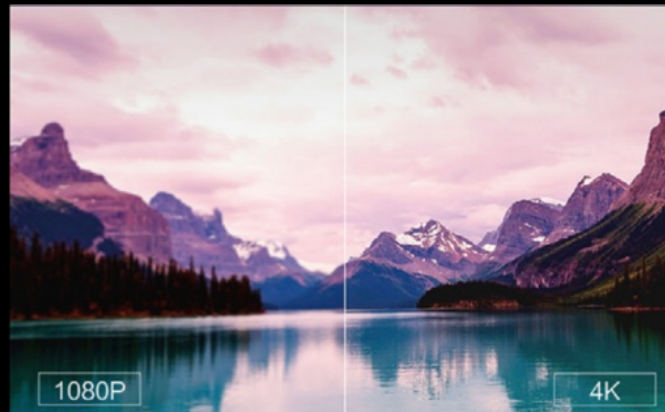

## Optical zoom, lens movement, installation and debugging more convenient

The projector has a lens movement function, which can translate the picture lossless through the menu, and users can easily adjust the position of the projected image. The maximum adjustment range of vertical direction is 50%(up), 10%(down), and the maximum adjustment range of horizontal direction is  $\pm 20\%$ .

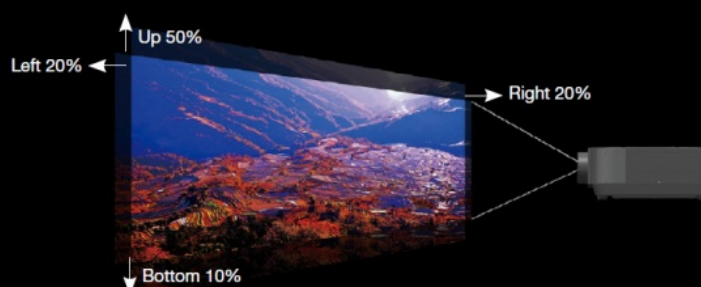



### 360° all-round projection

The projector supports 360° omni-directional projection, and the screen can be translated lossless through the menu. Users can easily adjust the position of the projected image.

\* Considering safety requirements, users must be used with protective cover.

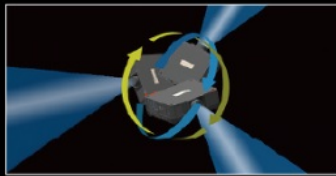

When users use the 360° projection function during **front and side** projection, The mandatory safety requirements, the protective cover structure is added to avoid the occurrence of **hazards**. Users must be equipped with a power shield to avoid unnecessary damage.

Please contact the authorized dealer to purchase the protective cover module whose P/N is **150000400**.

Schematic diagram of protective cover module (right)

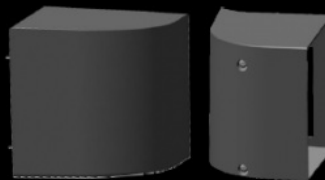

### Application:

Widely used outdoor projection, extra-large meeting rooms/househall/Academic Lecture Hall/hospital hall /big church/factory workshop and so on.

### Mail shipping package: (packed with two 5-layer double corrugated carton)



### Plug for global districts



### Company profile:

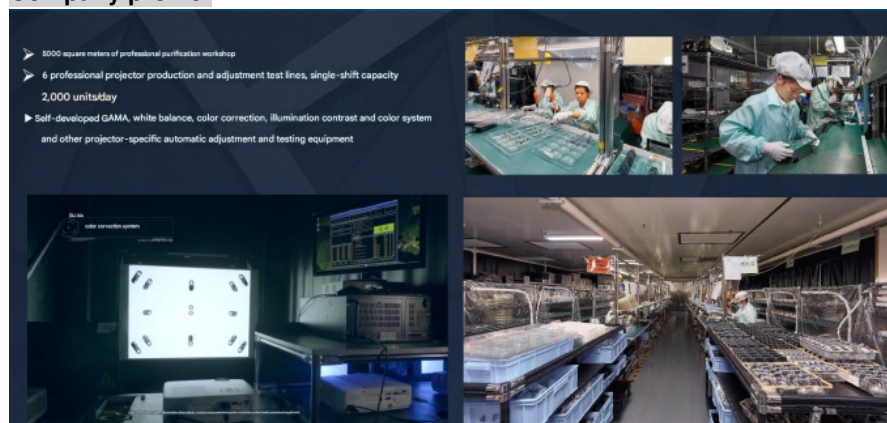

- the plastic injection molding factory was established to ensure stable supply and to produce optical engine bases for projectors
- Specialized thermosetting BMC molding equipment for optical engine bases with strict precision requirements
- The plastic molding equipment for high temperature resistant parts such as PPS, LCP, etc.
- The injection molding equipment has been expanded from 150 tons to 850 tons, and can independently produce PC + fiberglass shell products for projectors with safety requirements



- Vertical supply chain integration:
  - Special injection molding; molds; precision sheet metal, etc.
- Purpose:
  - Ensure supply and reduce delivery risks
- Controllable quality
- cost management

Professional projection product testing equipment, strict quality inspection



testing





testing

**Yeoan was established in 2009. We have been engaged in the research and development, production and sales of video and audio products since establishment.**

**After more than ten years of hard work, we have become one of the leaders in this field.**

**Our main mission is to provide the best visual and auditory experience through a series of excellent Audio-visual solutions, so that you can see and hear every detail accurately and clearly in your life and work.**

**We stand on the principle of reputation first and quality first, and we offer customized service for each customer in different regions and countries;**

**The most important is that we provide customers with accurate and stable delivery time, and efficient and high-quality after-sales guarantee.**

**Our products have a high reputation and occupancy rate both in domestic and foreign markets through continuous efforts.**

## **FAQ:**

### **1.Are you factory or trading company?**

We are the factory which have engaged in the research and development, production and sales of audio and video products since establishment.

### **2.What is your main products?**

Main products including projectors and its screen.

### **3.Is OEM & ODM available?**

We can provide customized solutions according to your requirements, such as personalized features or packages or brands based on the MOQ.

### **4.What is the delivery time?**

Generally is about 25 - 30 days if the products are out of stock or customized order.

### **5.What is the Payment?**

TT (bank transfer), LC at sight all will be accepted.

### **6.Sample available?**

Yes, we can provide a DEMO machine for testing.



**Hefei Yeoan Information And Technology Co.,Ltd.**



+8613866663080



zero@yeoan.com



projector-hd.com

No. 79 Kexue Avenue, Keyuan Pioneer Center, High-tech Zone, Hefei City, Anhui Province.